

**This Parcel**  
**Has 2 Dwellings**  
**Use Addresses on**  
**Operation Permits**  
**to determine location**  
**of Each**  
**Dwelling**  
**on Parcel**

Siler City - Snow Camp  
911 ADDRESS Road

Durena Phillips  
NAME / SUBDIVISION & LOT #

CHATHAM COUNTY HEALTH DEPARTMENT  
SEWAGE DISPOSAL OPERATIONS PERMIT

Date 5/1/00

Improvements Permit No. KW-2510

Owner Durena Phillips

Conditions Siler City - Snow Camp Rd.

This permit authorizes the owner to operate the sewage disposal system in accordance with the state and local rules. The department does recommend that septic tanks be pumped out every 3 to 5 years. In the event of a malfunction contact this office.

*Virginia Bryan / KW*  
Environmental Health Specialist

contractor = Bruce Clark  
tank + drainfield checked by R 5/1/00  
\* polylock effluent filter used

tank spec = PCC 1000  
STB 325  
12/19/99

MH site

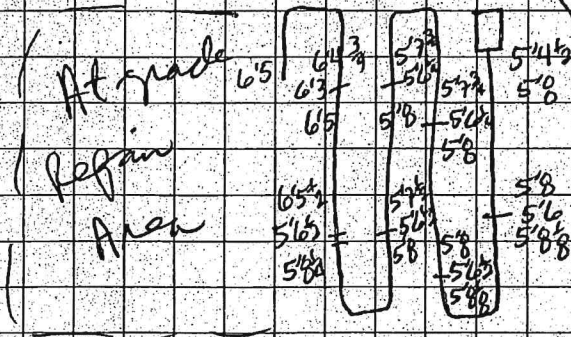

# CHATHAM COUNTY HEALTH DEPARTMENT SEWAGE DISPOSAL CONSTRUCTION AUTHORIZATION

Date 3/7/00

Improvements Permit No. KW-2510

Owner Dorene Phillips

Location SR 1004 Siler City - Snow Camp Rd. on right about 1/4 mile north of SR 1332 intersection.

This permit authorizes the property owner to install the sewage disposal system per Improvement Permit within five years of the issue date. The installer must be registered in Chatham County. Before an Operations Permit can be issued, all required inspections and conditions of the permit must be completed and verified by this department.

Plans (if required) approved by \_\_\_\_\_

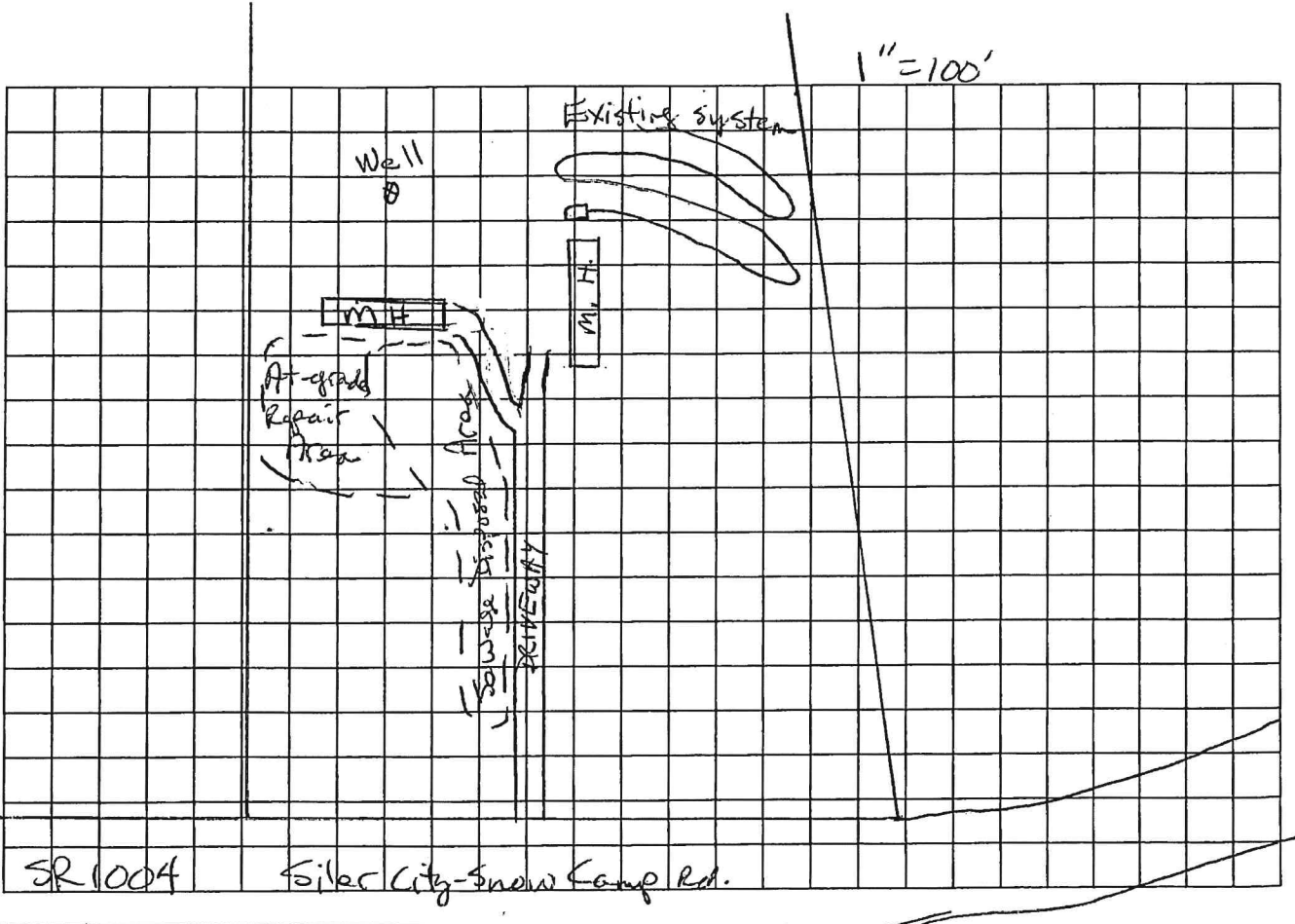

Existing well to be used.

Kim Warner, R.S.  
Environmental Health Specialist

poly lock effluent filter used  
PCC 1000 cast 12/19/99  
STB 325 date

NAME: Phillips, Dorene ADDRESS: 911 Siler City - Snow Camp Rd. COMPLETION DATE: 5/1/00

Permit

No. W02510

### CHATHAM COUNTY HEALTH DEPARTMENT ENVIRONMENTAL HEALTH DIVISION

80 E. Street  
P. O. Box 130  
Pittsboro, NC 27312

1000 S. 10th Avenue  
Siler City, NC 27344

#### IMPROVEMENT PERMIT FOR WASTEWATER SYSTEMS ARTICLE II-CHAPTER 130A OF THE NC GENERAL STATUES

An Improvement Permit is issued to Durane Phillips for  
a 6± acre site located on SR 1004 Siler City-Snow Camp Rd.  
in Chatham County. It is specifically issued for the following facility:

Facility: Residence  Business ( )  
 No. Bedrooms 3 No. Residents/Employees up to 6  
 Type Wastewater: Residential  Commercial ( )  
 Type System: Shallow Conventional  LPP ( )  
 Other \_\_\_\_\_  
 Design Flow 360 EGPD Application Rate .27 GPD/ft<sup>2</sup>  
 Size Tank(s) w/Risers ST 1000 Gal Pt \_\_\_\_\_ Gal  
 Nitrification Line (Length/Width/Max Depth) 440' x 3' x 18"

(On contour in surveyed septic area; solid earth dams every 50' for shallow conventional systems)

Type Repair at-grade conventional - .25 appl rate  
Special Conditions keep initial system in red soil near driveway.

A plat with site plan showing specific location of the facility, the site for the proposed wastewater system, existing buildings, property lines, water supplies, surface waters, the conditions for any site modifications; and any other information required by the department must be attached to be valid.

This permit is valid [ ] without expiration  for five years but is subject to revocation if the site is altered, soil disturbed, set-backs violated, or the plans of intended use are changed.

**THIS IS NOT AUTHORIZATION TO INSTALL.** An Authorization for Wastewater Construction must be obtained from this department before installation.

Environmental Health Specialist Kim Wanner R.S.  
Reg. No. 1237 Date 3/7/00

Name Phillips, Durane 911 Address Siler City - Snow Camp Rd.





CHATHAM COUNTY HEALTH DEPARTMENT  
ENVIRONMENTAL HEALTH DIVISION

80 EAST STREET  
P. O. BOX 130  
PITTSBORO, NC 27312  
542-8208

1000 S. 10TH AVENUE  
SILER CITY, NC 27344  
742-4911

**PRIVATE WELL & SEWAGE DISPOSAL SETBACK-COMPLIANCE APPROVAL**

A Re-inspection Permit is issued to P. D. Short

Original Permit Issued to: Pamela Love (1994)

Location From Hwy 64, north on SR 1004 Siler City - Snow Camp Rd. Driveway on right about 1/2 mile past SR 1332.

Water Supply: Private  Public

No. Bedrooms 2 Other \_\_\_\_\_

Reason for Re-inspection Replacing mobile homes  
Mobile home will not interfere with septic system.

SEPTIC TANK SHOULD BE PUMPED OUT EVERY 3 TO 5 YEARS AND SHALL BE MAINTAINED BY OWNER IN SUCH A MANNER AS NOT TO CREATE A PUBLIC HEALTH HAZARD.

DATE APPROVED: 6/13/01 BY: Kim Wannen, R.S.  
Environmental Health Specialist

**RE-INSPECTION PERMIT VALID FOR 6 MONTHS FROM DATE OF ISSUANCE.**

911 ADDRESS 4160 Siler City - Snow Camp Rd.  
Siler City, NC 27344

NAME/SUBDIVISION Short, P.D.